



new
Conrad

66

new
Conrad

CONRAD 66

The **CONRAD 66** is an elegant, 20 meter sailing yacht designed especially for the CONRAD Shipyard by a well known naval architect Juliusz Strawinski. It was designers intention to create beautiful yacht of noble traditional style for experienced sailors and their far and frequent journeys. She's not only the yacht giving satisfaction of sailing and exceptional comfort of living but also strong ship with the highest possible level of seaworthiness. She has steel hull and two engines of 160HP each, twin rudders, 2 folding propellers, a spacious professional A60 class engine room, large water and fuel tanks, as well as a big refrigerator, freezer and cupboards for food storage. All of this allows the CONRAD 66 to sail on long range operations in any weather conditions. Thanks to a bow-thruster in connection with two engines and a submersion of 2 meters provided by movable keel the yacht is able to moor easily in small, crowded and shallow marinas. There is a large storage place in the forepeak, a steel bathing platform with hydraulic opening door to the afterpeak, where besides storing diving equipment, a compressor and bicycles one can fit jet-ski or a small RIB. In the afterpeak there is space for everything that is indispensable for long range operations or recreation activities. Comfortable and easy to use tackling is ensured by an electric capstans, electric genoa roller (with the option of having also light genoa and storm sail roller) and electric main sail roller. Except for the steering station the cockpit contains also two tables and benches for 10-12 people. Thanks to the yachts width, the interior is exceptionally spacious. All the cabins are air-conditioned and have separate ventilation. Each cabin is furnished with a TV LCD and CD/DVD player and contains individual bathrooms. The interior is made of American cherry wood with wengé inlays. In the standard version the yacht encompasses a main cabin, 2 cabins for 2/3 people and extra 2 person cabin for guests or crew, a galley, a toilet, as well as, a spacious saloon with relaxing area for four people and a dining table for 10 people. In the saloon there is a discreet comfortable navigation area which is fully adapted to travel while on engines. All the possible comforts ONE can desire.





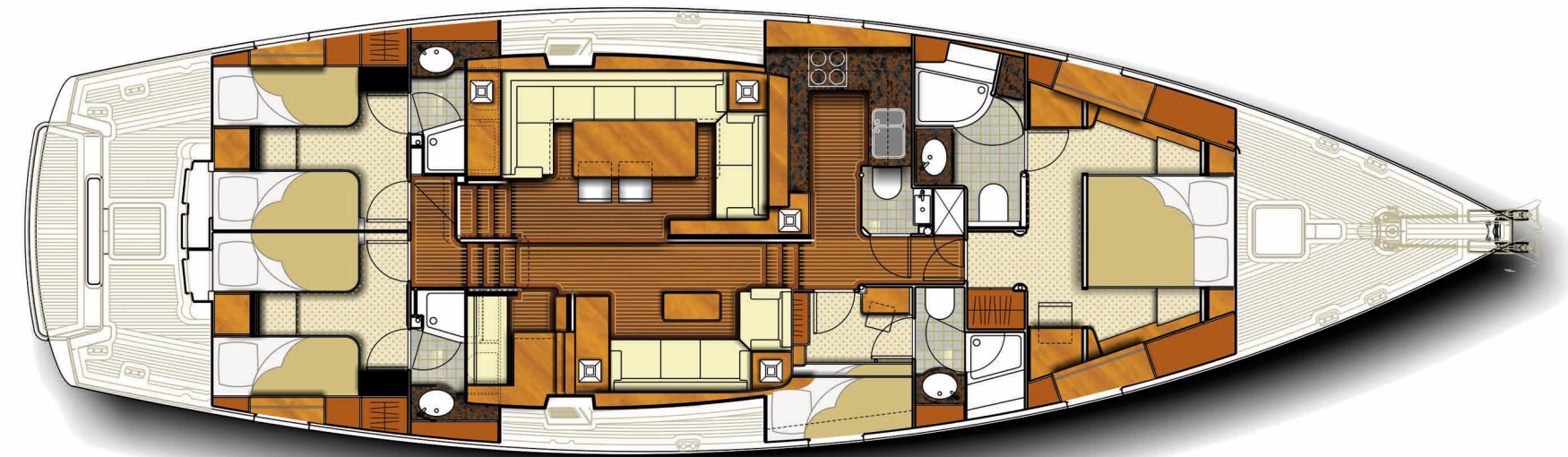
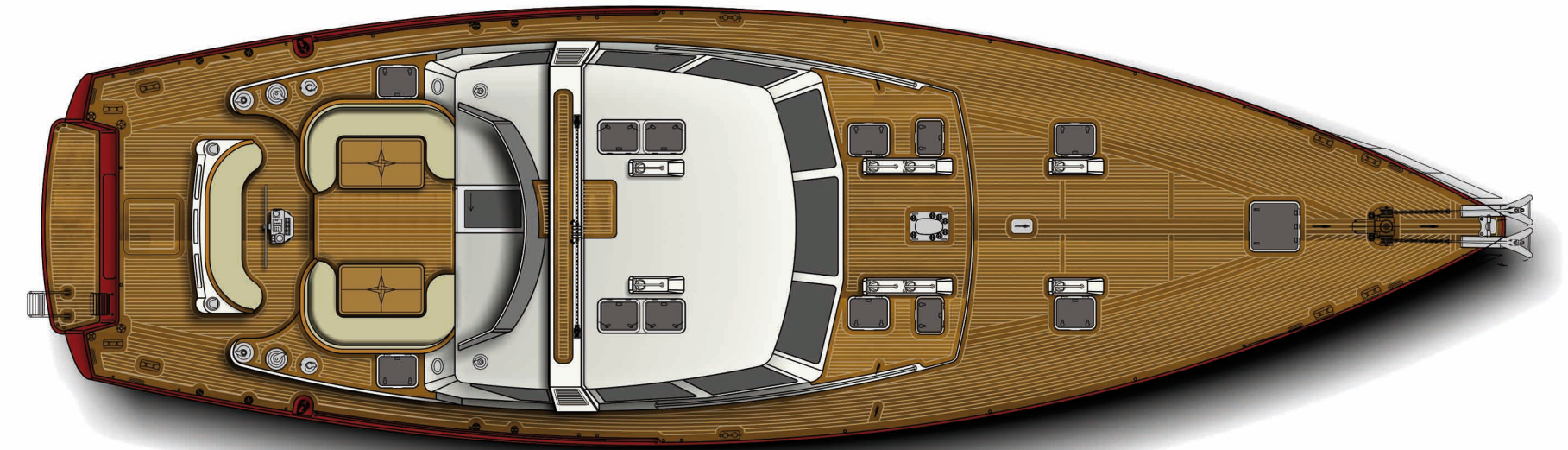







Length overall 20,16 m
Length waterline 16,72 m
Beam 6,06 m
Freeboard 1,80 m
Draft (centerboard up) 1,84 m
Draft (centerboard down) 3,88 m
Displacement 50,00 t
Ballast 4,00 t

Mainsail 86 sq . m
Genoa 130 sq . m
Light Genoa 150 sq . m
Inner jib 53 sq . m

Fuel tanks 2 470 l
Fresh water tanks 3 900 l
Drinking water stainless steel tanks 200 l
Sewage tanks 1 900 l

Main engines Yanmar 4LHAM 2x 160 HP
Generator Kohler 13EFOZD-EU1 13 kW 50
Cruising speed on one engine 7,5 kn

new
Conrad



CONRADSHIPYARD

WWW.CONRADSHIPYARD.COM