



CONRAD C144S – ACE



CONRAD 144S ACE

Launched in October 2022, C144s' ACE is the largest motor yacht model ever built in the shipyard's history, as well as in Poland. In C144s, the "s" stands for a straight bow which makes her even more superb, sleek, and sexy! The characteristic, modern, yet timelessly stylish design combines both the harmony of form and the ferocity resulting from the firm lines of the silhouette that ultimately shape the intriguing musculature of the yacht.

The spacious interior of the vessel with huge panoramic windows provides extraordinary comfort and atmosphere on board, offering an owner's suite plus 4 VIP cabins, as well as 4 double cabins for the crew and a captain's cabin on the bridge. The outer deck is a clever combination of many multi-functional zones, starting from the fantastic aft platform with a beach club, through 4 amazing lounge zones, deck cinema, 2 bars, and 2 dining zones, ending with the infinity pool on the highest deck.

Designed by Raymond Langton Design, with naval architecture by Diana Yacht Design, and interior decor created by M2 Atelier, it has been recognized as one of the most spectacular launches of the season. ACE has received over 9 awards, including a Judges Commendation at the World Superyacht Awards 2023, Two International Yacht and Aviation Awards 2023, and the Design Elite Award 2023, the World Yacht Trophy 2023, Three Neptunes at the Boat Design and Innovation Contest, and the Miglio Blue Award.

C144S is Conrad's first semi-custom model and is available for clients within 24 months. The second hull #2 in the series - EXTRA TIME - was delivered to the client in April 2024, and the third unit #3 is currently under advanced construction with the delivery date scheduled for Spring 2025. Hull number #4 is available for sale.

ACE

Superb, Sleek and Sexy!



„The boat is a magnificent combination of harmony, elegance, and sophisticated craftsmanship. This is an entirely different world inside and outside. A piece of art and timeless sculpture, I said to myself with a pride when I saw first C144S ACE on the water for the very first time”

Mikołaj Król, Conrad's Chairman and CEO

Unmatched cruising experience



Meeting the highest demands of quality

"Our signature undercut "rolling wave" on the superstructure reflects the sky above and the water below, simultaneously casting captivating shadows on the decks as the sun moves across the sky"

Reymond Langton Design Studio



State of the art

Timeless piece



Optimized relationship between space and structure







"The spaces allowed us to experiment and push the boundaries. Every corner of the boat was designed to create spaces that were like those found in much larger vessels"

M2 Atelier









Poland's largest superyacht model launched to date







Finest design



Supreme level of luxury living







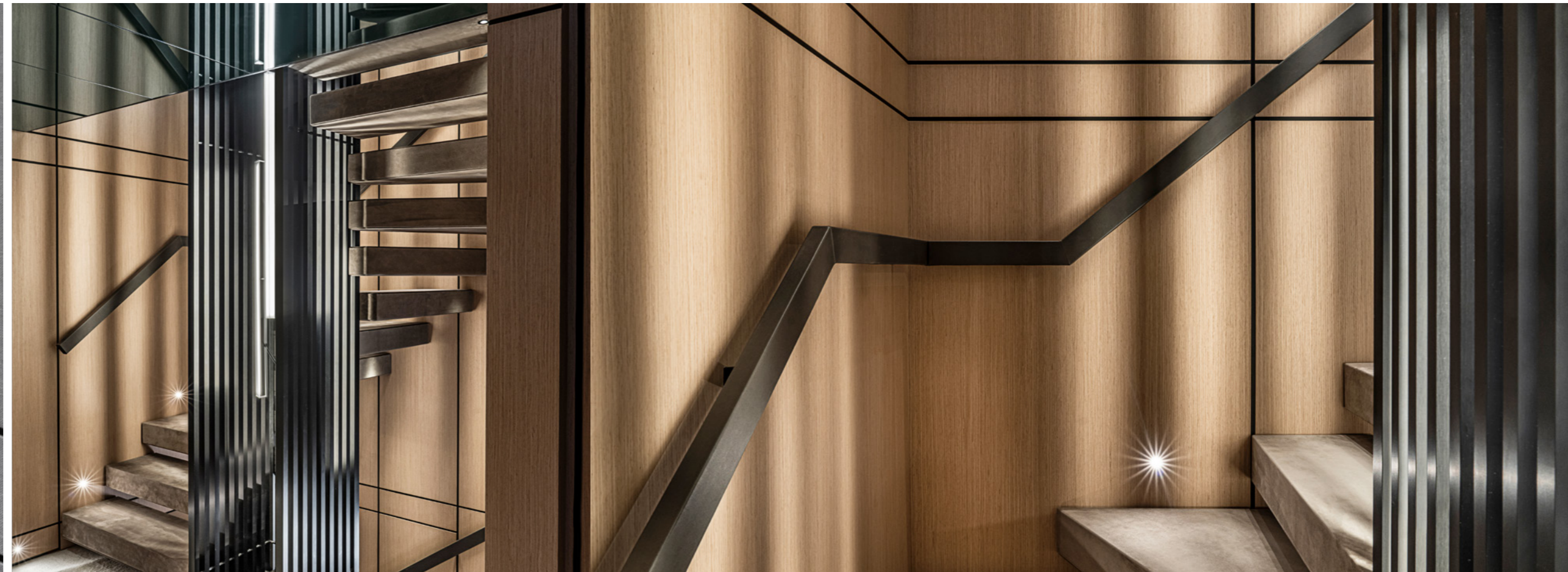





Knowledge, experience and technical background



Type Full Displacement Motor
 Hull construction Steel
 Superstructure Aluminium
 Gross Tonnage 497 GT
 Class LR ✕ 100A1 SSC Yacht Mono G6,
 [✕] LMC-UMS, MCA REG Yacht Code

Length overall 44.27 m (145 ft. 3 in.)
 Length at waterline 42.98 m (141 ft.)
 Beam 8.90 m (29 ft. 2 in.)
 Draft 2.45 m (8 ft.)
 Displacement approx. 472 t
 Cruising/max speed 11/13,8 kts
 Range @ 10 kts 5,100 NM

Fuel capacity 51300 l (13552 gal.)
 Fresh water capacity 11710 l (3093 gal.)
 Sewage capacity 11300 l (2985 gal.)

Main engines 2x CAT C18 ACERT, B-rated,
 500kW @ 2100rpm
 Gearboxes 2x ZF W650
 Generators 2x CAT C7.1 118 kW
 Stabilizers CMC Electric Zero Speed
 Nav-com Furuno, Boeing

Hydraulic system Feebe
 Air-conditioning Condaria
 Sewage treatment Hamann AG

Exterior Design Raymond Langton
 Naval Architecture Diana Yacht Design
 Mechanical engineering Conrad Shipyard
 Interior Design M2 Atelier

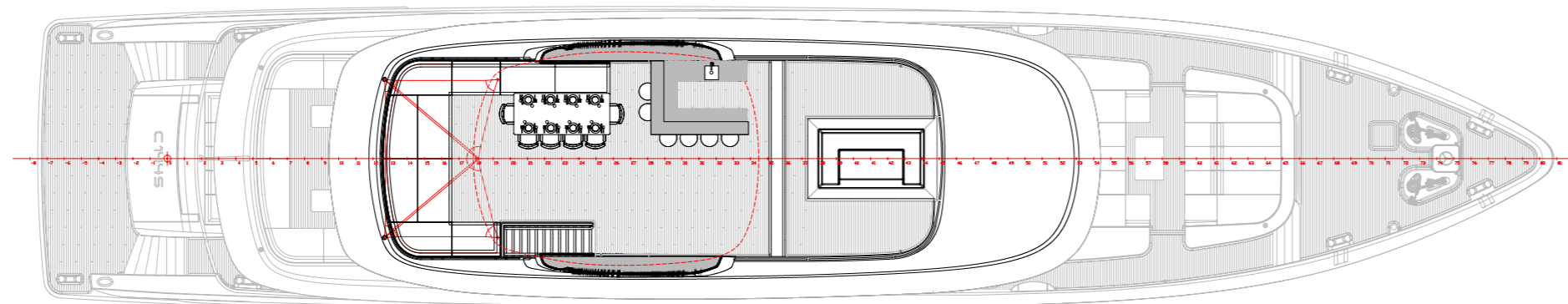

SUN DECK

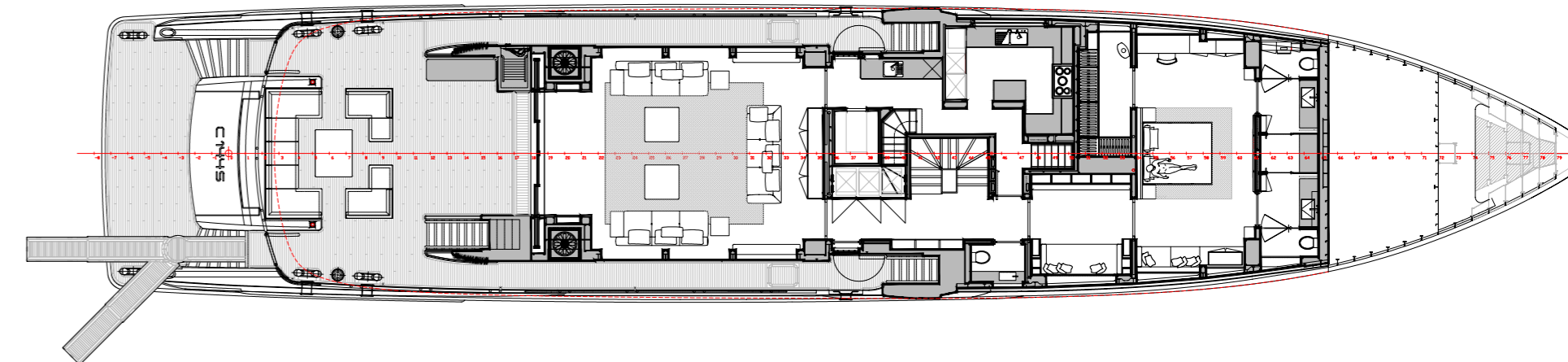

MAIN DECK

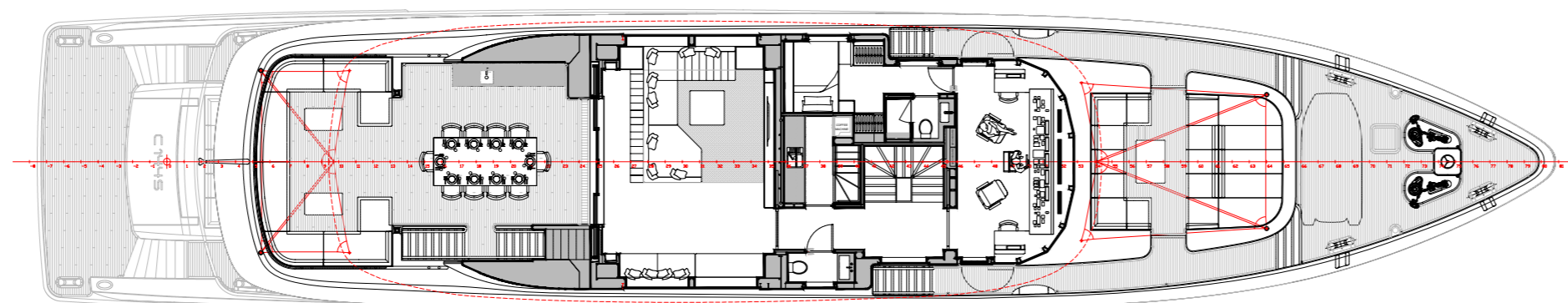

BRIDGE DECK

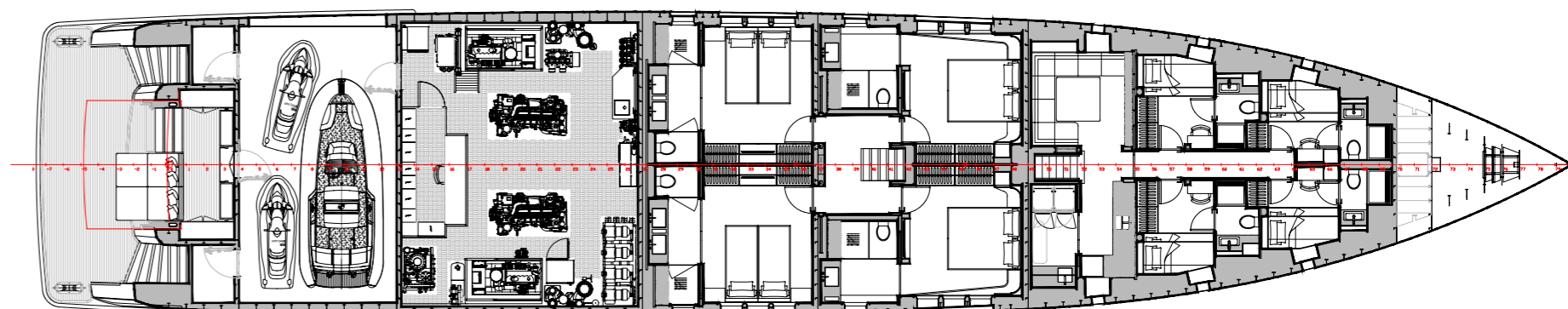

LOWER DECK

CONRAD
SHIPYARD
Celebrates 20 *years*

Conrad S.A.
ul. Sienna 45, 80-605 Gdansk, Poland
tel. +48 58 320 56 00, fax +48 58 320 56 01
e-mail: conrad@conradshipyard.com
www.conradshipyard.com